

FUNCTIONS

WML WHITE & WMLx WHITE LIGHT OPERATION

Constant

With LED lever pointing forward in Position (A) press button once to turn on constant white light. Pressing button again or moving the lever from Position (A) to Position (B) will turn the light off.

In constant mode, momentary is also available. Press and hold button for more than ½ second to turn light on. Release pressure off button to turn light off.

Momentary

With LED lever pointing backward in Position (B) press and hold button to turn light on. Release pressure off button to turn light off.

Strobe

With the LED lever pointing forward in Position (A) quickly press button twice to activate strobe. Pressing button again or moving lever from Position (A) to Position (B) will turn light off.

WML WHITE/IR & WMLx WHITE/IR LIGHT OPERATION

Constant (IR)

With LED lever pointing backward in Position (B) press button once to turn on constant IR light. Pressing button again or moving lever from Position (B) to Position (A) will turn light off.

Momentary (IR)

With LED lever pointing backward in Position (B) press and hold button to turn light on. Release pressure off button to turn light off.

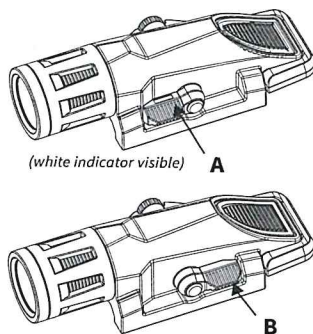

DISABLING STROBE

1. Unscrew head ¼ rotation to lockout position.
2. Press and hold button.
3. While holding button, tighten clockwise back into place. Once tightened, release button and strobe will be disabled. Repeat steps 1 - 3 to enable strobe.

OPERATION

MOUNTING WML & WMLx TO RAIL

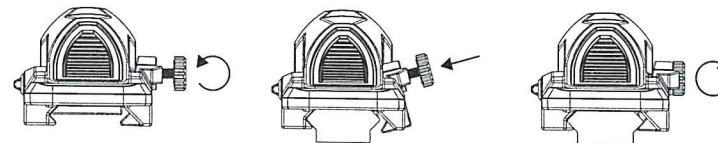

1. Turn clamp screw counterclockwise until completely loosened.
2. Push clamp toward body and place onto rail. Release pressure off clamp once on rail.
3. Finger tighten screw clockwise until secured on rail. DO NOT USE TOOLS.

To dismount light, turn clamp screw counterclockwise until completely loosened. Push clamp toward body and lift off rail.

LOCKOUT SYSTEMS

There are two lockout methods to prevent accidental discharge when carrying light.

1. Safety lever protects activation of button. Lift lever up 90° to cover button.
2. Unscrew head ¼ rotation.

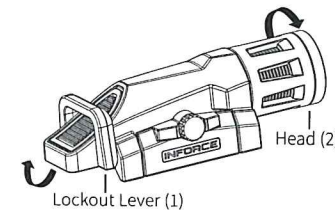

BATTERY REPLACEMENT

1. Unscrew head to remove it from body.
2. Insert one battery (WML units), or two batteries (WMLx units) into body. Positive (+) side first as shown in the figure below.
3. Screw head back into body.

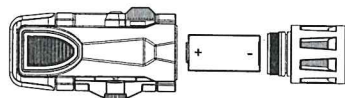

WARNING: Lithium batteries can explode or cause burns if recharged, shorted, disassembled, exposed to water or high temperatures of fire. Follow battery manufacturer's guidelines for safe storage, use and disposal. If light has been submerged, dry exterior of light prior to replacing batteries. Fresh and salt water will damage internal electronics and batteries.

Do not use counterfeit or inferior quality batteries, as they do not meet safety and performance standards and may cause personal and property damage. Ensure safety and performance by purchasing established brands, such as: Duracell, Energizer, or Panasonic.